

LOGISTICS PACK

EU-ToxRisk Case Study meeting

25-26 Nov. 2019

Hotel Zuiderduin

Egmond aan Zee, The Netherlands

Venue

Meeting venue:

Hotel Zuiderduin
Zeeweg 52 - 1931 VL
Egmond aan Zee (NL)

Tel.: +31 (0)72-750 2000

<http://www.zuiderduin.nl/>



How To Get There & Back

Egmond aan Zee is situated around 45 km from Amsterdam and does not have a train station.

Shuttle buses have been organised to get participants to the conference location and back to the airport/train station:

	ARRIVAL: Shuttle to the hotel	DEPARTURE: Shuttle to the airport/train station
	24/11	26/11
SCHIPHOL AIRPORT	19:00 21:00	14:45 16:30
AMSTERDAM CENTRAAL TRAIN STATION	19:30 21:00	14:45 16:30

If your destination upon arrival is **Schiphol Airport**, please go to the **Meeting Point** close to Burger King, where the **shuttle driver** will wait for you and the other passengers with an 'EU-ToxRisk' sign.

If your destination upon arrival is **Amsterdam Centraal**, please head to the **KISS & RIDE spot WEST in the back left** of the station building, where the **shuttle driver** will be waiting for you and the other passengers with an 'EU-ToxRisk' sign.

SHUTTLE: In case of delays or problems in locating the shuttle bus driver, please call Taxi Tromp on +31 (0)72 574 30 00.

If you wish to get to Egmond aan Zee by means of **public transport**:

- **From Schiphol:** Take a train to Alkmaar (online ticket purchase on <https://www.ns.nl/en>) and change at Amsterdam Sloterdijk. In Alkmaar, take the n°165 bus to Egmond aan Zee and get off at the Zeeweg stop (about 30 min.).
- **From Amsterdam Centraal:** Take a train to Alkmaar (40 min.), You can book your train ticket online at <https://www.ns.nl/en>, then board the n°165 bus to Egmond aan Zee (30 min.). Get off at the Zeeweg stop.

Floor plan



Etage 0

STAIRCASE TO ETAGE 1

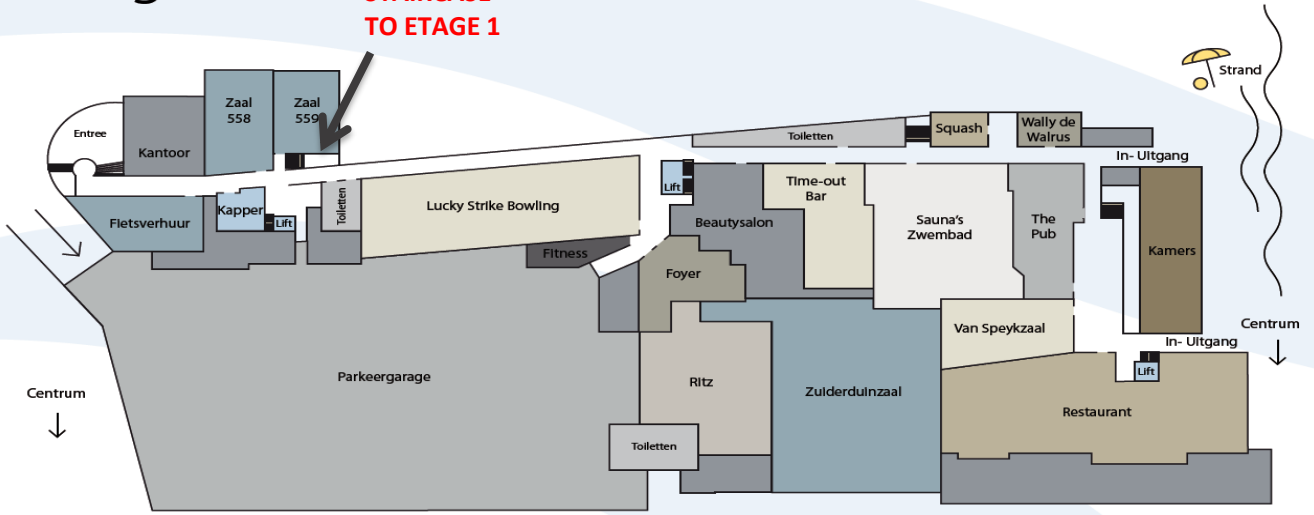

v.14



Etage 1

BREAKOUT ROOMS

PLENARY MEETING ROOM

WELCOME DESK

COFFEE BREAKS/LUNCH

ENTRANCE

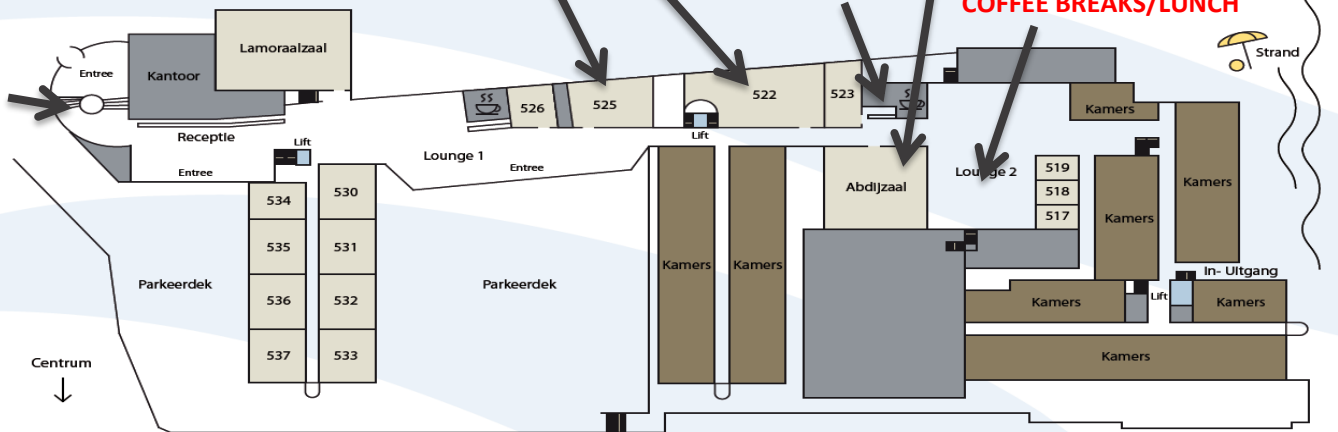

Etage 4

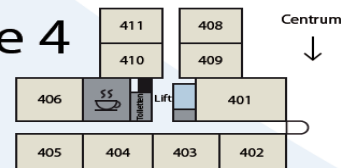

v.14

Additional Information

CONTACTS

EU-ToxRisk Project Office by e-mail:

eu-toxrisk-arttic@eurtd.com

EU-ToxRisk Project Office by phone:

+33 (0)1 53 94 54 81 (Elisabeth – Office in Paris)

+31 (0)72 750 20 31 (on site, Zuiderduin)

TAXI TROMP SHUTTLE SERVICE (last-minute issues, e.g. delayed flights/trains on arrival):

+31 (0)72 574 30 00

WIFI AT THE HOTEL

Network: ZDuinWIFI
(no password needed)

Network : ZDbusinessWIFI
Username: ZDGuest
Password: hotel

WORK DINNER

Mon 25 Nov 2019 at 19:00pm:

Restaurant Natuurlijk, Doctor Wiardi
Beckmanlaan 8, 1931 BW Egmond.

Meeting point for group departure:
18:45pm in the hotel lobby.