

Print it and bring it along!

Logistics Pack

EU-ToxRisk

Open Symposium & General Assembly

12 - 14 February 2019

Hotel Zuiderduin

Egmond aan Zee, The Netherlands

Venue

Meeting venue:

Hotel Zuiderduin
Zeeweg 52 - 1931 VL
Egmond aan Zee (NL)

Tel.: +31 (0)72-750 2000

<http://www.zuiderduin.nl/>



How To Get There & Back

Egmond aan Zee is situated around 45 km from Amsterdam and does not have a train station.

Shuttle buses have been organised to get participants to the conference location and back to the airport/train station:

| | ARRIVAL: Shuttle to the hotel | | DEPARTURE: Shuttle to the airport & train station | | |
|-----------------------|----------------------------------|----------------|--|-------|-------------------------|
| | 11/02 | 12/02 | 12/02 | 13/02 | 14/02 |
| Schiphol | 13:15 20:00 | 09:00 09:45 | 18:30 | 16:00 | 13:30 16:30 17:45 |
| Amsterdam Centraal | 13:15 20:00 | 09:00 09:45 | 18:30 | 16:00 | 13:30 16:30 17:45 |

If your destination upon arrival is **Schiphol Airport**, please go to the **Meeting Point** where the **shuttle driver** will wait for you and the other passengers, with an 'EU-ToxRisk' sign.

If your destination upon arrival is **Amsterdam Centraal**, please head to the **KISS & RIDE spot at the rear left** of the station building, where the **shuttle driver** will be waiting for you and the other passengers, with an 'EU-ToxRisk' sign.

SHUTTLE: In case of delays or problems in locating the shuttle bus driver, please call Taxi Tromp on +31 (0)72 574 30 00.

If you wish to get to Egmond aan Zee by means of **public transport**:

- *From Schiphol:* Take a train to Alkmaar (~10.00 EUR full-fare, one way; online ticket purchase on <https://www.ns.nl/en>) and change at Amsterdam Sloterdijk. In Alkmaar, take the n°165 bus to Egmond aan Zee and get off at the Zeeweg stop (about 30 min.; ~2.50 EUR one way).
- *From Amsterdam Centraal:* Take a train to Alkmaar (40 min., ~8 EUR, one way), You can book your train ticket online at <https://www.ns.nl/en>), then board the n°165 bus to Egmond aan Zee (30 min., ~2.50 EUR one way). Get off at the Zeeweg stop.

Hotel Plan



Etage 0

**STAIRCASE
TO ETAGE 1**

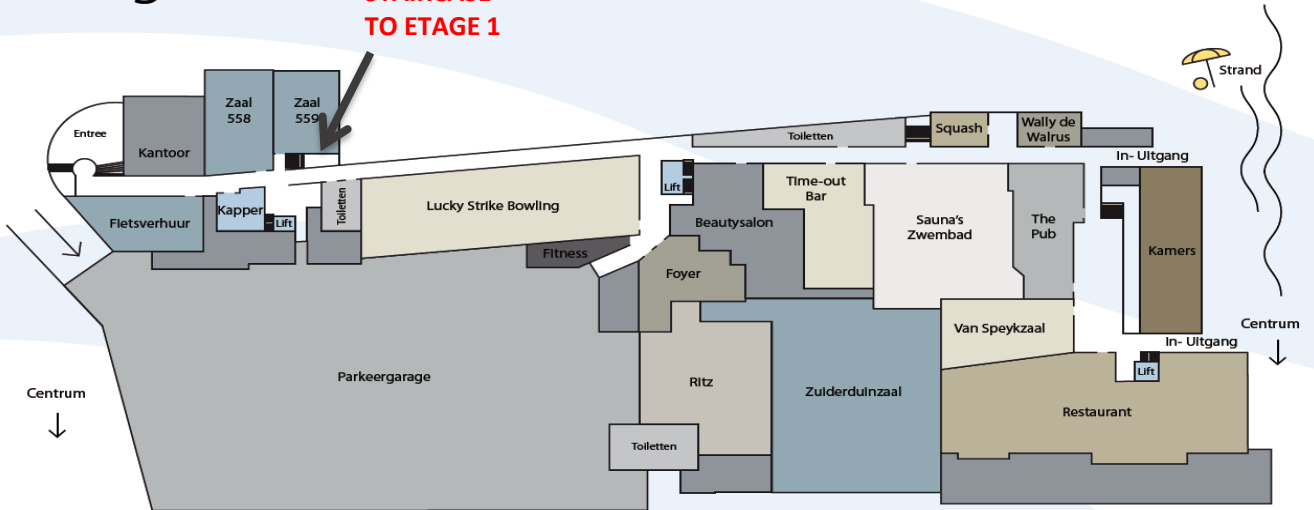

v.14



MAIN MEETING ROOM

Etage 1

**POSTERS,
COFFEE BREAKS,
LUNCH**

WELCOME DESK

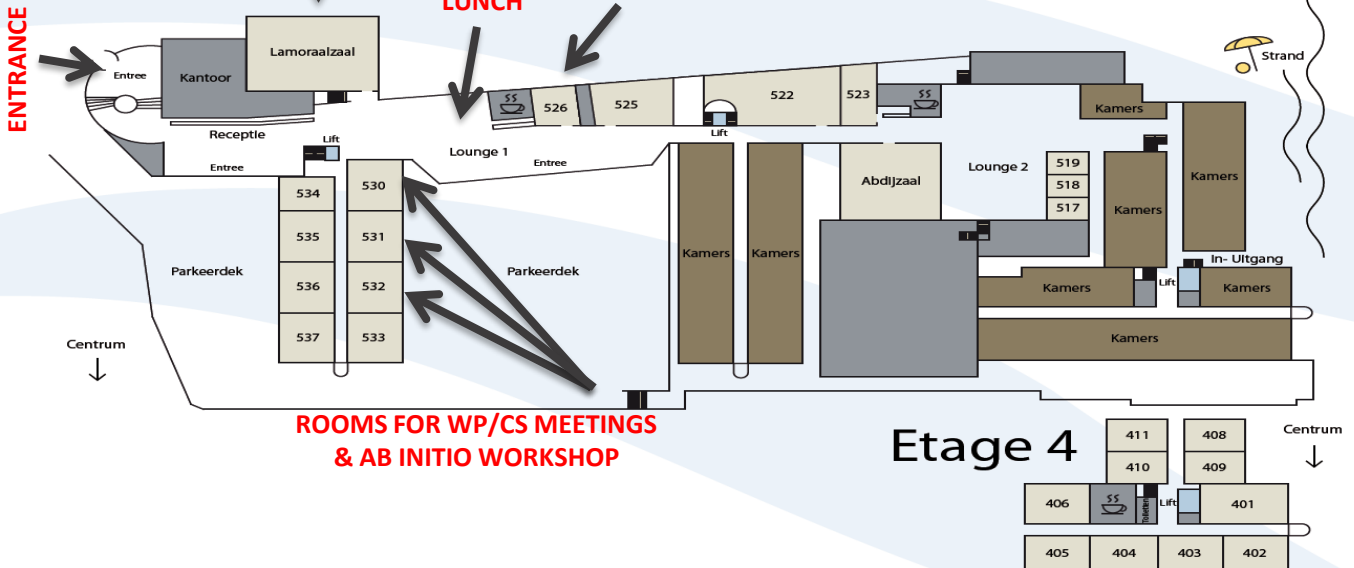

v.14

Additional Information

CONTACTS

EU-ToxRisk Project Office by e-mail:

eu-toxrisk-arttic@eurtd.com

EU-ToxRisk Project Office by phone:

+33 (0)1 53 94 54 81 (Elisabeth – Office in Paris)

+33 (0)1 53 94 54 79 (Charlotte – Office in Paris)

+31 (0)72 750 20 31 (on site, Zuiderduin)

TAXI TROMP SHUTTLE SERVICE (last-minute issues, e.g. delayed flights/trains on arrival):

+31 (0)72 574 30 00

WIFI AT THE HOTEL

Network: **ZDuinWIFI**
(no password needed)

SOCIAL EVENTS

Tue. 12 Feb. 2019:

Dinner at the Van Speijk restaurant,
Westeinde 1, 1931 AB Egmond aan
Zee

Wed. 13 Feb. 2019:

Dinner at the Zilte Zoen restaurant,
Boulevard 2, 1931 CJ Egmond aan
Zee