

Print it and bring it along!

Logistics Pack

EU-ToxRisk Case Studies Meeting

11 - 12 June 2018

Hotel Zuiderduin

Egmond aan Zee, The Netherlands

Venue

The EU-ToxRisk Case Studies Meeting takes place from 11-12 June 2018 in Egmond aan Zee, The Netherlands, and is hosted by the Hotel Zuiderduin (see the address below).

The CS 1 / 2 / 4 / 9 work sessions will be held on Mon. 11 June. 2018, after a plenary introductory session to set the stage.

The CS 2 / 3 / 4 / 8 work sessions will take place on Tue. 12 June 2018. The meeting will close with a plenary debrief session.



Hotel Zuiderduin
Zeeweg 52 - 1931 VL
Egmond aan Zee (NL)

T: +31 (0)72-750 2000

<http://www.zuiderduin.nl/>

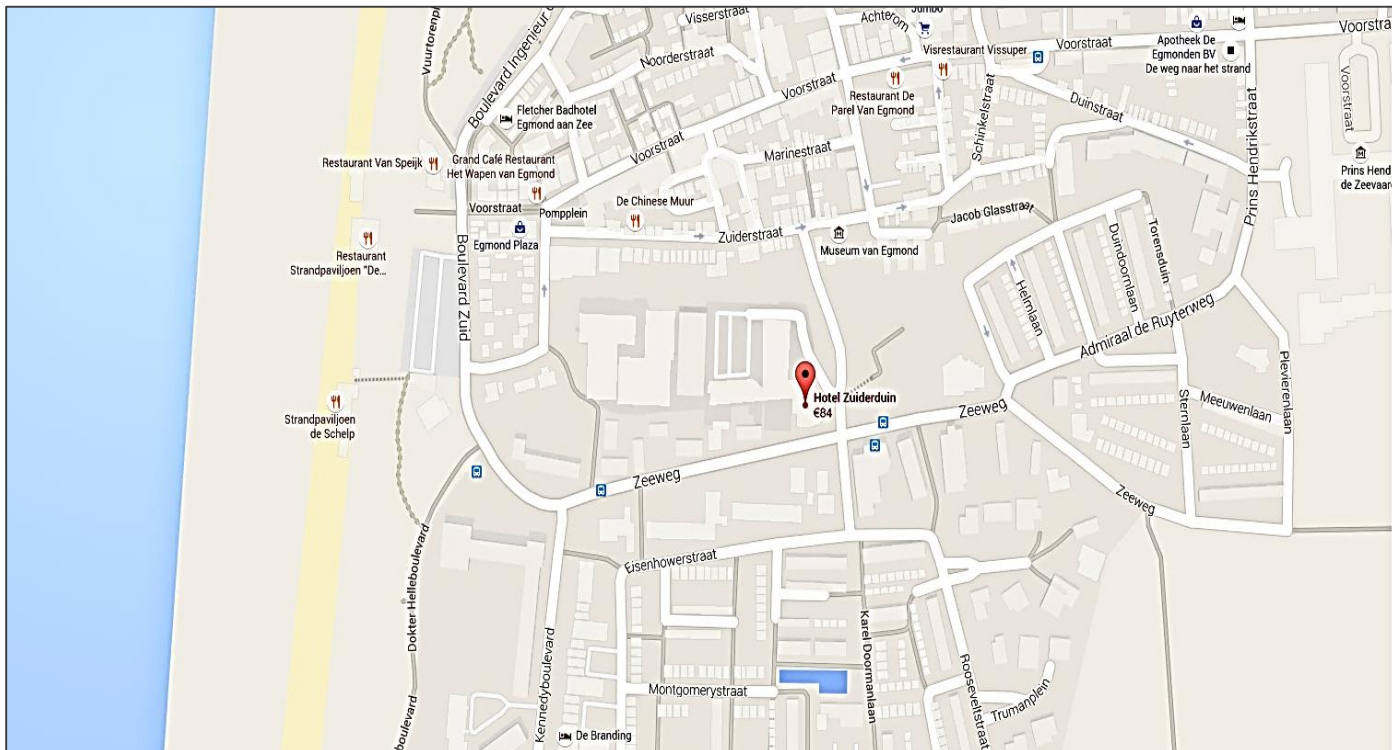

How To Get There & Back

Egmond aan Zee is situated around 45 km from Amsterdam and does not have a train station. Shuttle buses have been organised to get participants to the conference location and back to the airport/train station:

	ARRIVAL: Shuttles to the hotel		DEPARTURE: Shuttle to the airport & train station
	10/06	11/06	12/06
Schiphol	18:30 20:30	18:00	17:00
Amsterdam Centraal	20:00	18:00	17:00

If you arrive at Schiphol airport, please head to the so-called [Meeting Point](#) where the shuttle driver will be waiting for you with an 'EU-ToxRisk' sign.

If you arrive at Amsterdam Centraal, you should head to the [Kiss&Ride pick-up spots](#) at the back of the train station, where the shuttle bus driver will be waiting for you with the same 'EU-ToxRisk' sign.

In case of delays, or problems in locating the shuttle bus driver, please call **Taxi Tromp** on **+(31)-72-5743000**.

If you wish to get to Egmond aan Zee by other means of public transport:

- From Schiphol: Take a train to Alkmaar (€9,30 full-fare, one way) and change at Amsterdam Sloterdijk. In Alkmaar, take the n°165 bus to Egmond aan Zee and get off at the Zeeweg stop (about 30 minutes; €2,35 one way).
- From Amsterdam Centraal: Take a train to Alkmaar (40 mins, €7,50 full fare, one way), then board the n°165 bus to Egmond aan Zee (30 mins, about €2,35 one way). Get off at the Zeeweg stop.

Hotel Plan



Etage 0

STAIRCASE TO ETAGE 1

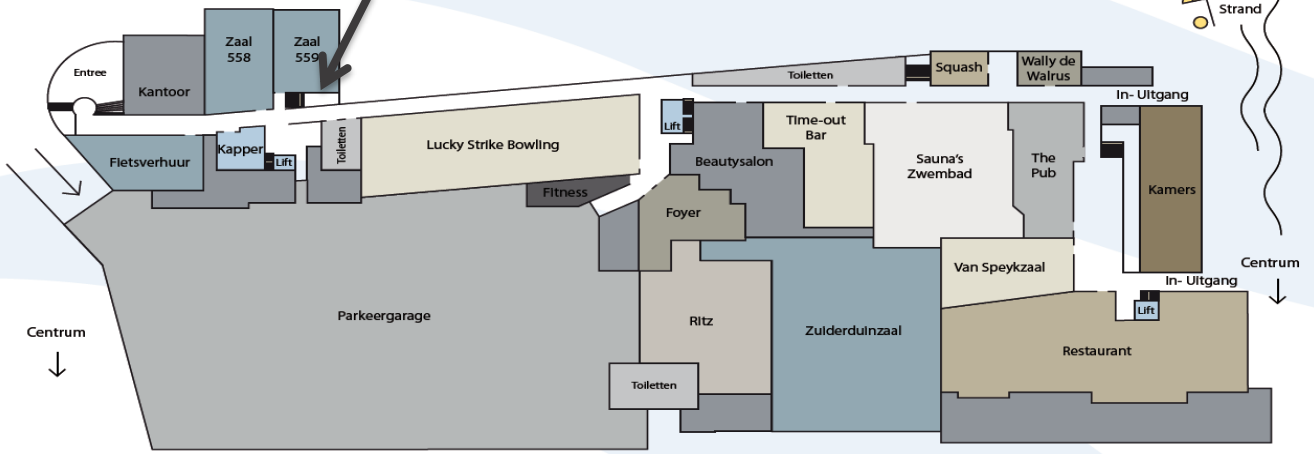

v.14

BREAKOUT ROOMS

MAIN MEETING ROOM

Etage 1

WELCOME DESK

COFFEE BREAKS

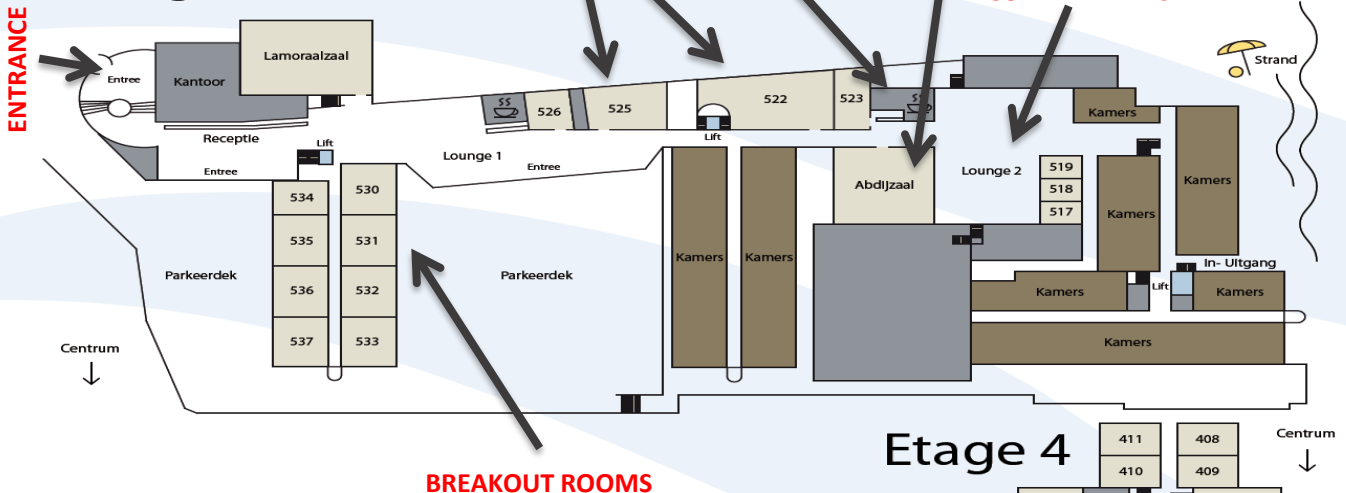

BREAKOUT ROOMS

Etage 4

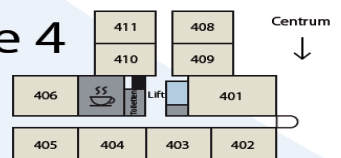

v.14

Additional Information

SOCIAL EVENT

11 June 2018

Dinner, 19:45 ([Restaurant Van Speijk](#), 5 min. walk from the hotel)

WIFI LOG-IN

ZDBusinessWIFI

Username: ZDGuest

Password: hotel

Or

ZDuinWIFI

Password: Hotel@Zee

(no username)

CONTACT – Project Office

EU-ToxRisk Project Office:

eu-toxrisk-arttic@eurtd.com

Elisabeth Graf

+33 (0)1 53 94 54 81

+33 (0)7 84 19 34 99 (on site)

Martin Stroleny

+33 (0)7 69 28 57 77 (on site)